

TOWNSHIP OF ORONOCO

PREPARED BY THE
MINNESOTA DEPARTMENT OF TRANSPORTATION
OFFICE OF TRANSPORTATION SYSTEM MANAGEMENT

IN COOPERATION WITH
U.S. DEPARTMENT OF TRANSPORTATION
FEDERAL HIGHWAY ADMINISTRATION

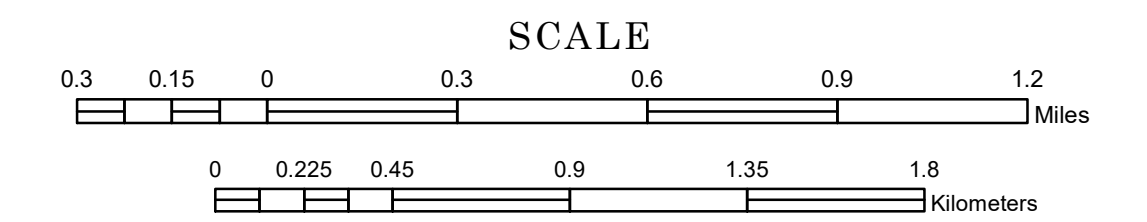

1 in = 1,600 ft

2024

Projection:
Transverse Mercator
NAD 1986
UTM Zone 15

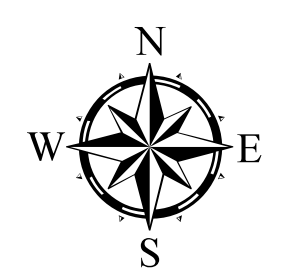

North American Datum
of 1986

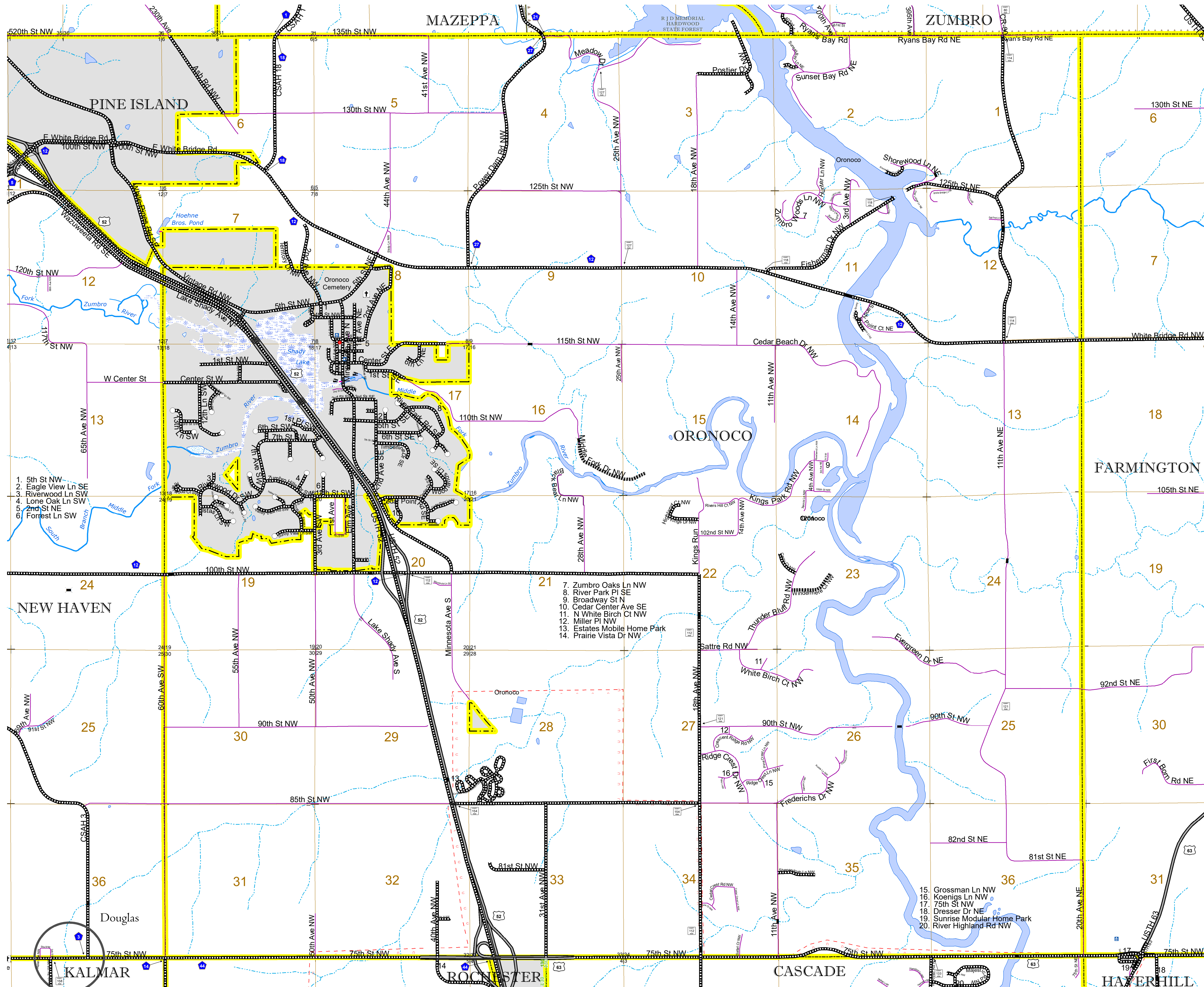

ROAD AND ROADWAY FEATURES		AVIATION FEATURES	
INTERSTATE	CONCRETE	COMMERCIAL AIRPORT	GENERAL AIRPORT
US HIGHWAY	BITUMINOUS	AIRSTRIP	SEAPLANE
MN HIGHWAY	GRAVEL	AIRPORT RUNWAY	RAILROAD AND RAILWAY FEATURES
COUNTY STATE AID HIGHWAY	DIRT/UNIMPROVED	EMPIRE BUILDER STATION (AMTRAK)	NORTHSTAR STATION (COMPUTER)
COUNTY ROAD	OTHER	BLUE LINE	GREEN LINE
TOWNSHIP ROAD	UNKNOWN	LONG BRIDGE (200' OR GREATER SPAN)	MAJOR BRIDGE (20' TO 300' SPAN)
UNORGANIZED TERRITORY ROAD	RAMP OR CONNECTOR	MINOR BRIDGE (5' TO 20' SPAN)	DAM
OTHER ROADS	INTERSTATE EXIT	LOCK AND DAM	CITY CENTERS
Municipal	GREAT RIVER ROAD	STATE CAPITAL	COUNTY SEAT
National Service	UNORGANIZED TERRITORY ROAD	CITY CENTER	CITY CENTER
National Monument	UNORGANIZED TERRITORY ROAD	UNINCORPORATED COMMUNITY	UNINCORPORATED COMMUNITY
National Wildlife	UNORGANIZED TERRITORY ROAD	MNDOT OFFICE	MNDOT TRUCK STATION
State Park	UNORGANIZED TERRITORY ROAD	HIGHWAY PATROL DISTRICT OFFICE	STATE TRAVEL INFORMATION CENTER
Present	UNORGANIZED TERRITORY ROAD	REST AREA (Full Service)	REST AREA (Vault Toilet)
	UNORGANIZED TERRITORY ROAD	WAYSIDE (Vault or Pit Toilet)	PARK AND RIDE LOT
	UNORGANIZED TERRITORY ROAD	PORT OF ENTRY	PUBLIC ACCESS POINT
	UNORGANIZED TERRITORY ROAD	MN STATE COLLEGE AND UNIVERSITY SYSTEM (MNSCU)	UNIVERSITY OF MN SYSTEM
	UNORGANIZED TERRITORY ROAD	FARMS	CULTURAL FEATURES
	UNORGANIZED TERRITORY ROAD	STATE HISTORICAL MARKER	HISTORIC DISTRICT
	UNORGANIZED TERRITORY ROAD	HISTORIC SITE	HISTORIC SITE
	UNORGANIZED TERRITORY ROAD	MONUMENT	MONUMENT
	UNORGANIZED TERRITORY ROAD		

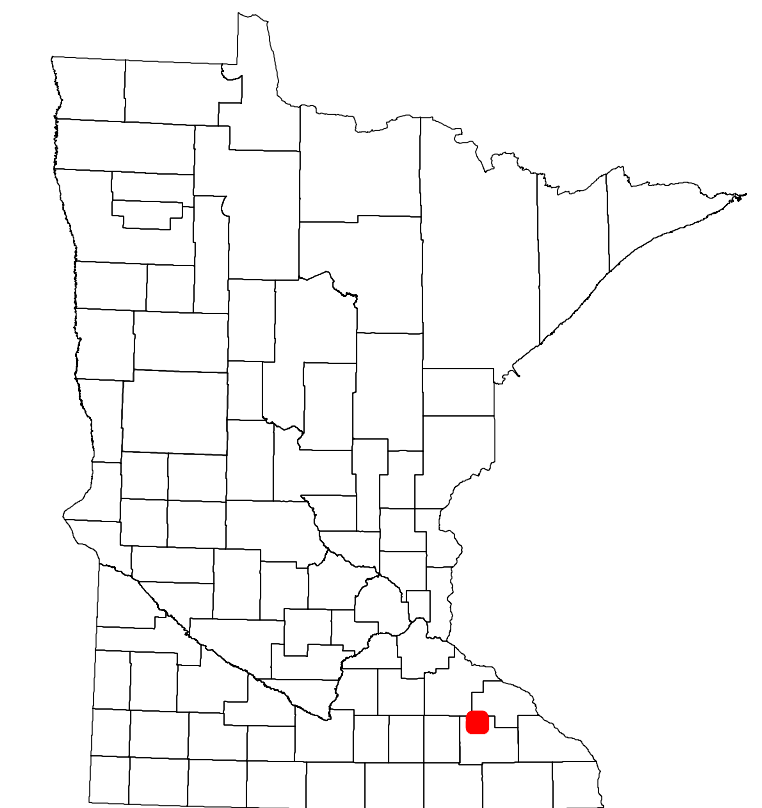

Population (U.S. Census 2010): 2220

To request information from this document in an alternative format, call 651-366-4718 or 1-800-657-3774 (Greater Minnesota); 711 or 1-800-627-3529 (Minnesota Relay). You may also send an e-mail to ADRequest.dot@state.mn.us. (Please request at least one week in advance.)