

- OPTION PREFERRED**
- ADVANTAGES:**
- OPTIMAL PARKING LOT CIRCULATION
 - SHELTER ON EXISTING LEVEL PAD (NO DISRUPTION TO NATURAL LANDSCAPE AND NO FILL NECESSARY)
 - SHELTER PROVIDES PARK USERS WITH OPTIMAL ACCESS AND CONNECTION TO THE WATERFRONT
 - SHELTER HAS OPTIMAL VIEWS OF THE LAKE (STRAIGHT NORTH)
 - SHELTER IS LOCATED ON A LEVEL PAD WHERE THE PRIOR RESTAURANT WAS LOCATED
 - SHELTER IS CENTRALLY LOCATED TO SERVE ALL PARK USERS AND PROVIDES SAFE AND CONVENIENT ACCESS FROM ADA PARKING
 - SHELTER AND RESTROOM HAVE ADEQUATE SEPARATION
 - ALLOWS FOR LOADING/UNLOADING AT SHELTER FROM THE PARKING LOT
 - CONSTRUCTION OF THE PARKING, SHELTER, AND RESTROOM SAVES THE EXISTING SHADE TREES IN THE BAY
 - RESTROOM IS COMPLETELY OUT OF SETBACK
- DISADVANTAGES:**
- SHELTER PARTIALLY WITHIN SIZ

IMPERVIOUS CALCULATION		
	PHASE ONE	PHASE TWO
EXISTING IMPERVIOUS	53,075 SF	16,412 SF
PROPOSED IMPERVIOUS	42,490 SF	19,624 SF
NET CHANGES IN IMPERVIOUS	-10,285 SF	3,212 SF

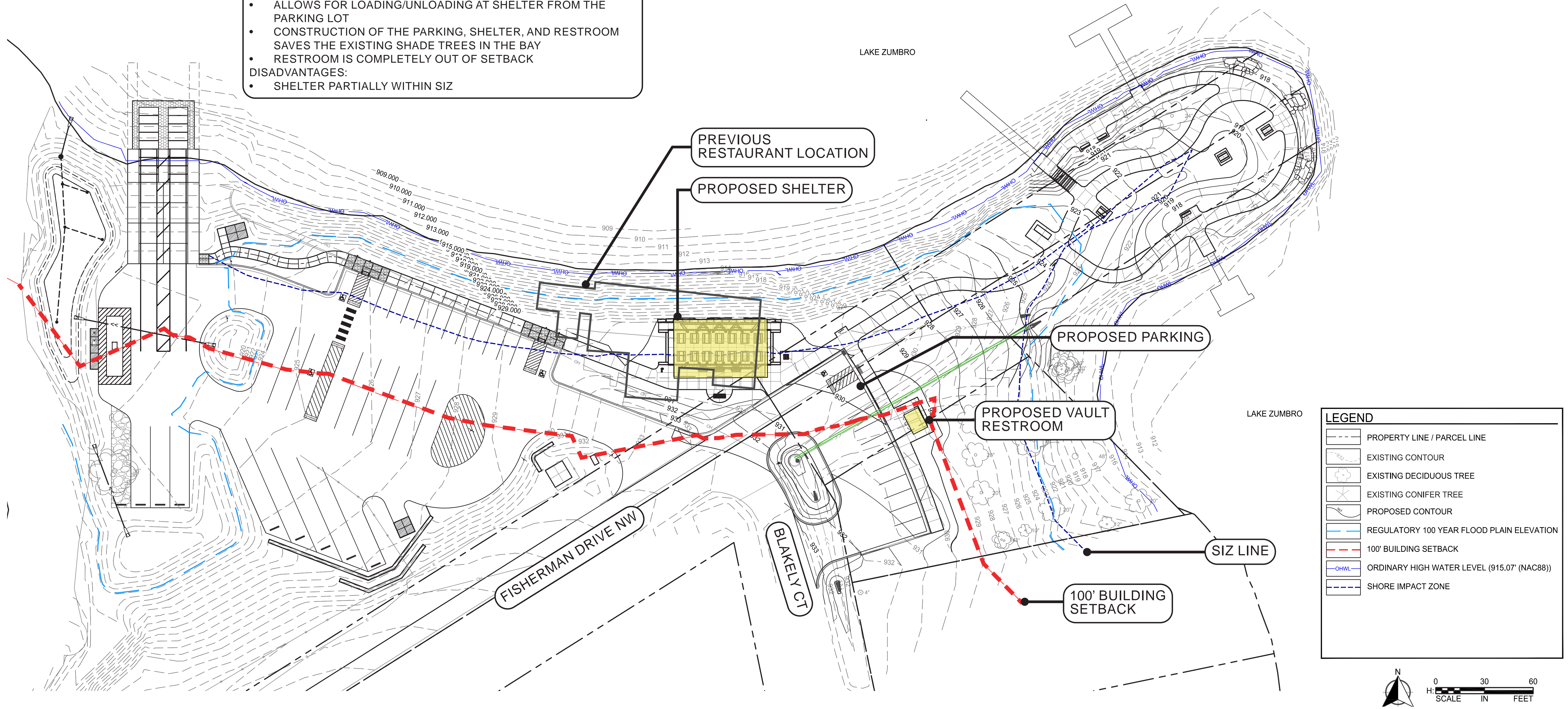

LEGEND

- PROPERTY LINE / PARCEL LINE
- EXISTING CONTOUR
- EXISTING DECIDUOUS TREE
- EXISTING CONIFER TREE
- PROPOSED CONTOUR
- REGULATORY 100 YEAR FLOOD PLAIN ELEVATION
- 100' BUILDING SETBACK
- ORDINARY HIGH WATER LEVEL (915.07' (NAC88))
- SHORE IMPACT ZONE

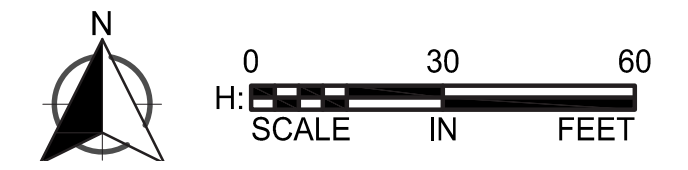

Lake Zumbro Park Phase 2 | Site Plan Preferred

Oronoco, Minnesota
2026 | WSB Project number: 031052-000

Scale in Feet

C:\ACCA\CCDocs\WSB\031052-000\Project Files\05_Discipline\Permitting\Phase 2 Permits\Exhibits\031052-000-Lake Zumbro Site Plan Options_2026-0501